



ONE LESS MOVE

On the move

REFERENDUM UPDATE

New PK-5 Claremont Road School - Design Development Update
HIGHLIGHTS FROM Public Presentation to FTPS BOE on 12 November 2015

MISSION STATEMENT

- To build environmentally friendly, healthy, learning spaces;
- In a way that is supportive of the School District's academic mission;
- So that the Claremont Road School building will serve as a model of innovative strategies for conserving resources.

HIGH PERFORMANCE GOALS

- Energy Star 90 (26.9 Kbtu/SF)
- 50% Water Use Reduction
- 100% Daylighting In All Instructional Spaces
- Provide High Quality Indoor Air Environment
 - Low VOC Materials
 - Displacement Ventilation
 - Monitoring of CO₂
- Maintain High Acoustical Quality Of School



LEED Charrette



Inclusive
Process

STAKEHOLDERS

- Team included administrators, educators, & staff
- Hands-on involvement by Dr. John Ravally, James Strimple, Rick Goet, Connie Coriell, Dr. Jeff Charney, Roberta Mitchell, Rebekah Solomon, Brian Bonanno, Dr. Brenda Sofield, Dr. John Roberts, Albert Fico, Madlen Rizkalla, Tania Kelly, Miguel Rivera, Evelyn Rutledge, John Haney, Lonni Mountainland, & Margaret DeBlasi

SCHEMATICS

- Schematic Design Meetings every 2 weeks
- Building Tour to view LEED features & options
- Discussion on Circulation, Room Adjacencies, Layouts, Sizes, Instructional Activities, and Space Utilization
- Discussion on Site Orientation & Site Development

DESIGN DEVELOPMENT

- Design Development Meetings every 2 weeks
- Discussion on Furniture Layouts & Equipment
- Discussion on Materials, Finishes, Supervision, Safety, Security, Utilization, Maintenance and Operations

Claremont Elementary School



View of Main Entrance

Claremont Elementary School



View of Bus Entrance



Claremont Elementary School



View of Courtyard (facing North)

Claremont Elementary School



View of Courtyard (facing South)

Claremont Elementary School



SSP Architectural Group

Overall Front Elevation (showing Gym Wing)



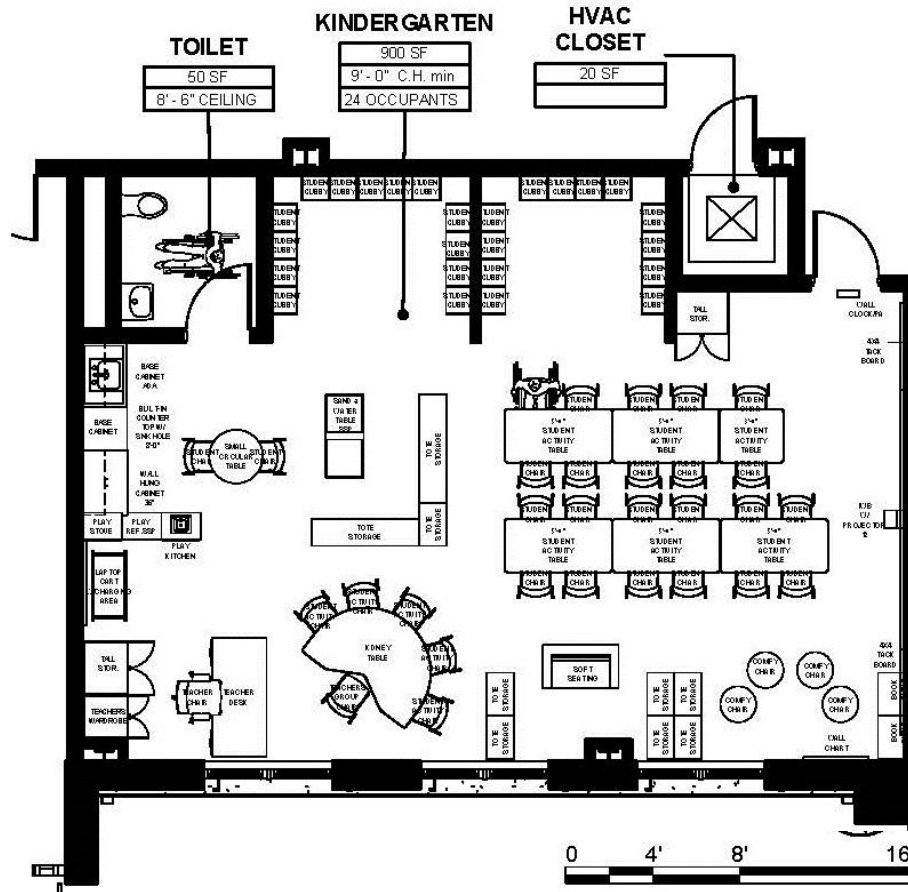

Claremont Elementary School

